

# The Digby Series

BLWD - Wrap

Project		Date	
Part		Type	

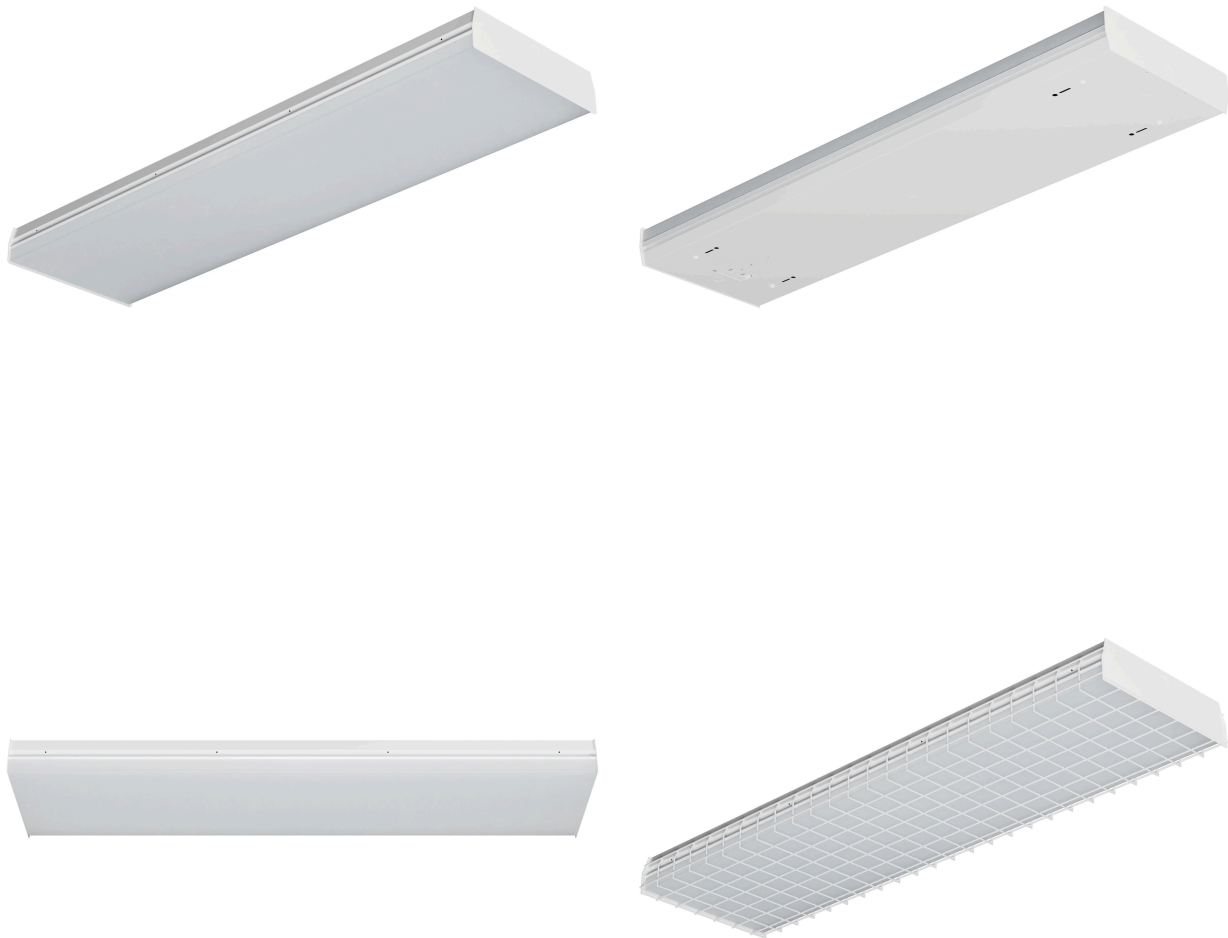

## About The Digby Series

The BLWD is an LED wrap fixture designed for surface and suspended mounting. It is well suited for use in office spaces, hallways, anapplications where existing luminaires can be replaced with a new energy efficient LED fixture while covering existing ceiling lines anunpainted areas.

## Specifications

Supported Voltage	120-277V, 347V, 120-347V, 480V
Available Sizes	4'
Lifetime	L70 of 230,000+ hours, L90 of 70,000+ hours
Operating Temperature	-20°C/+25°C
Lumens	Lumen output ranging from 2L (2000lm) to 6L (6000lm)
CCT	2700K, 3000K, 3500K, 4000K, 5000K, 6500K
CRI	80+ standard, 90+ and 95+ available
Dimming	0-10V Standard
Mounting	Holes provided for V-hangers, S-hook chain-mounting, or aircraft cables

## Approvals

- ETL Listed
- Dry and Damp Environment Rated
- Designed and Manufactured in Canada

## Warranty

- 5 Year Comprehensive, 10 Year LED

# The Digby Series

BLWD - Wrap

Wrap Lighting by **BJTAKE**  
LIGHTING

## Ordering Information

Fill in the fields below with your product selections. If you need help with this section, [contact your local sales professional](#).

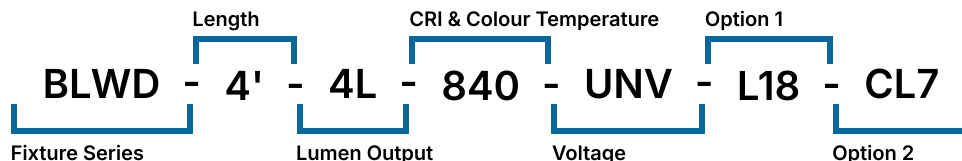

1	2	3	4	5	6				
BLWD									
Series	Size	Lumen Output		CRI	CCT	Voltage			
BLWD	4'	2L	2,000lm	8	80	27	2700K	UNV	120-277V
		3L	3,000lm	9	90+	30	3000K	347	347V
		4L	4,000lm	1	95+	35	3500K	UN3	120-347V
		5L	5,000lm			40	4000K	480	480V
		6L	6,000lm			50	5000K		
						65	6500K		
7									

## Options

### Lenses

BLANK Frosted Acrylic

### Cords

W3xx White 16/3 (Specify Length)  
W4xx Black 16/3 (Specify Length)  
W59xx White 16/5 (Specify Length)  
W\*\*\* Other Options Available\*

Key.	Cord Length.	Key	Cord Length
6	6FT	15	15FT
10	10FT	20	20FT

Ex. W406 would be 16/3 Black, 6FT

### Motion Sensors

W26 Photocell Motion Sensor  
W57 Dimming Motion Sensor (dims to 50% when unoccupied)  
W53\* On/Off  
W8\* High/Low  
WX16 Microwave Dimmable Sensor  
W\*\* Other Options Available\*

### Dimming

B11 0-10V Dimming Leads  
B12 Line Voltage Dimming  
B27 Dim-to-off Driver  
B\*\* Other Options Available\*

### Controls

WC10\* Encelium Wireless Controls  
WC18\* NX Wireless Controls  
WC19\* Avi-on Wireless Controls  
WC22\* JDRF Wireless Controls  
WC31\* Keilton Wireless Controls

### Emergency Driver

B17 UL924 10W Battery Back-up  
F8 UL924 Emergency Relay

### Wire Guard

G1 Heavy Duty White  
G5 Heavy Duty Black

### Finish

BLANK Standard Gloss White  
C5 Matte Black  
CUSTOM\* Custom Colour Choice

### Packaging

BLANK Individually Boxed on Pallets  
P0 Bulk Packaging

### Mounting

M1 V-Hangers  
M2xx V-Hanger with Aircraft Loop Cables  
M3xx Y-Toggle Aircraft Cables  
M24 Single Pendant Mount(3/4 Hub)  
M\*\* Other Options Available\*

Key.	Aircraft Length.	Key	Aircraft Length
5	5FT	15	15FT
10	10FT	20	20FT

Ex. M305 would be Y-Toggle, 5FT

### Warranty

CL7 10-Year Comprehensive Warranty Upgrade





# The Digby Series

BLWD - Wrap

Wrap Lighting by **BJTAKE**  
LIGHTING

## Certifications and Listings

Certifications that apply to this fixture and its possible configurations are listed here. More information available upon request.

Icon	Description
	ETL Listed
	Wireless Controls Available
	90 and 95+ CRI Options Available
	120-347V(UN3) Available

## Usage Applications

This fixture can be used in a variety of applications, and is ideal for the following:

Usage Application
Aisle Lighting
Displays
Grocery Stores
Hospitals
Offices
Retail Stores
Schools
Task Lighting
Suspended
Surface Mount

## Warranty Statement

BJ Take products are tested and/or inspected prior to being packaged for shipment and are guaranteed from the day the product is shipped for a period of ten-year LED chip warranty and a five-year comprehensive component warranty. This can be upgraded to a ten-year comprehensive warranty on request.

BLWD 4' Side

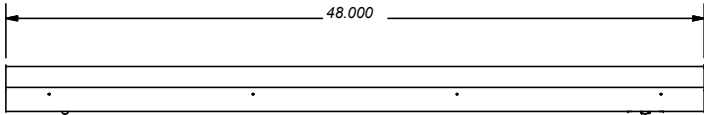

BLWD 4' End

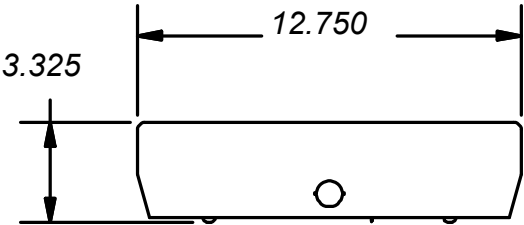

BLWD 4' Top

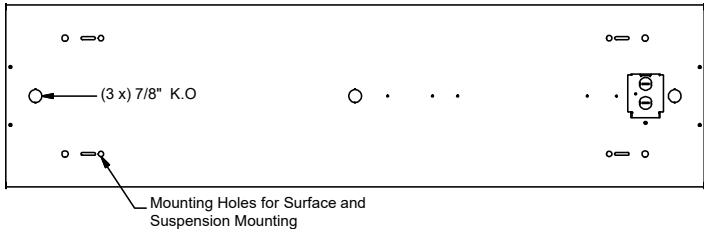

BLR 4' Wattage

Length	Lumen Output	Actual Lumen Output	Wattage	Lumens per Wattage
4'	2	2124	17	123.06
4'	3	3136	24	130.67
4'	4	4148	32	129.63
4'	5	5160	40	129.00
4'	6	6172	48	128.58

\* Drawings aren't to scale  
\* Standard tolerances apply  
\* Specifications may change without notice

# The Digby Series

BLWD - Wrap

Wrap Lighting by **BJ TAKE**  
LIGHTING

## BLWD-4FT-2L-840-L18

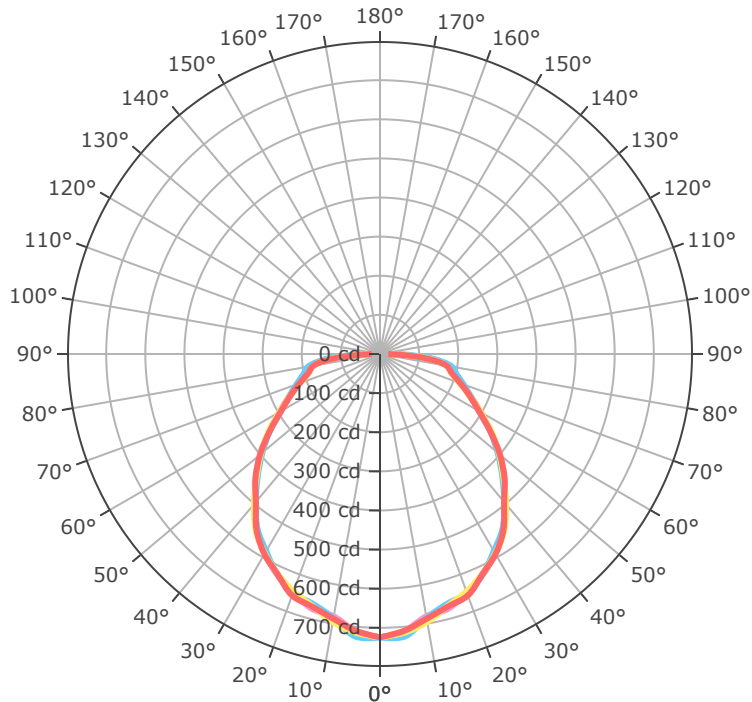

0.0°  
45.0°  
90.0°  
135.0°  
180.0°

Mtg Height	Light Level	Beam Diameter
6.0 ft	20.1 fc	16.1 ft
8.0 ft	11.3 fc	21.5 ft
10.0 ft	7.2 fc	26.9 ft
12.0 ft	5.0 fc	32.3 ft
14.0 ft	3.7 fc	37.7 ft
16.0 ft	2.8 fc	43.1 ft
24.0 ft	1.3 fc	64.6 ft
32.0 ft	0.7 fc	86.1 ft
40.0 ft	0.5 fc	107.7 ft
48.0 ft	0.3 fc	129.2 ft
56.0 ft	0.2 fc	150.7 ft
64.0 ft	0.2 fc	172.3 ft

## BLWD-4FT-6L-840-L18

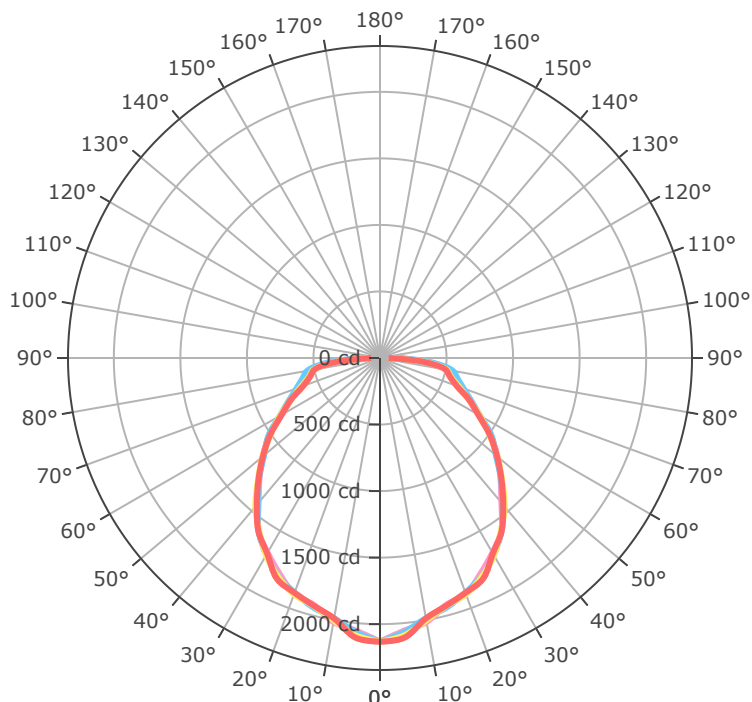

0.0°  
45.0°  
90.0°  
135.0°  
180.0°

Mtg Height	Light Level	Beam Diameter
6.0 ft	59.2 fc	15.9 ft
8.0 ft	33.3 fc	21.2 ft
10.0 ft	21.3 fc	26.5 ft
12.0 ft	14.8 fc	31.8 ft
14.0 ft	10.9 fc	37.1 ft
16.0 ft	8.3 fc	42.4 ft
24.0 ft	3.7 fc	63.5 ft
32.0 ft	2.1 fc	84.7 ft
40.0 ft	1.3 fc	105.9 ft
48.0 ft	0.9 fc	127.1 ft
56.0 ft	0.7 fc	148.2 ft
64.0 ft	0.5 fc	169.4 ft

## Emergency Battery Plan - 10W

Emergency Lighting	Solution System Components	System Operation
Option Code 'B17' - UL 924 listed components that are factory installed in the luminaire	UL 924 listed 10-watt battery integral to the luminaire	Loss of normal power is detected by the B17 emergency light solution and the power supply is switched automatically to the 10-watt integral battery pack which powers the emergency LED lighting driver.
	UL 924 listed LED emergency lighting driver integral to the luminaire	The battery pack and emergency LED driver are UL 924 certified to provide a minimum of 90-minutes of emergency lighting.
	Wiring options for both switched and unswitched emergency lighting	

## Emergency Lighting Wiring

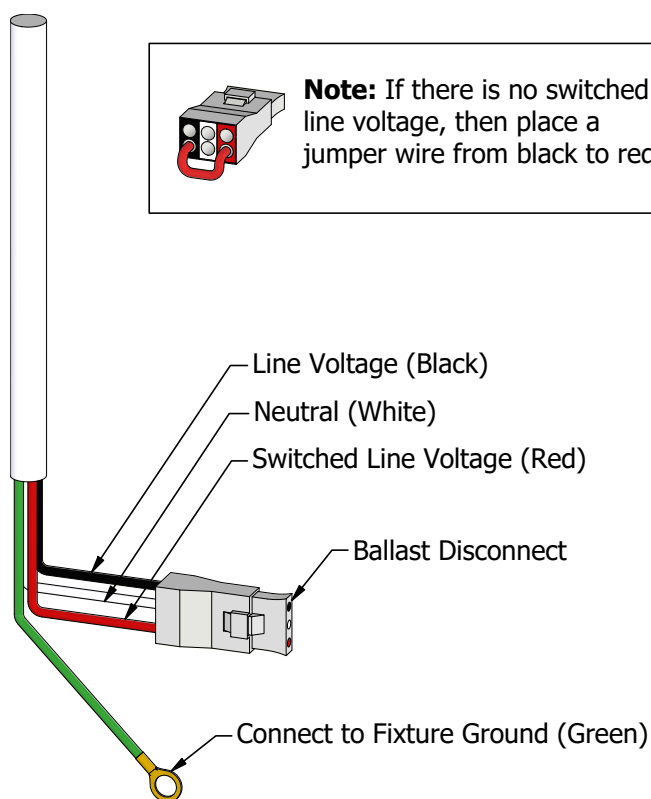

## Important Information

More information on emergency lighting options and configurations available on request.

## Gallery Information

Below you will find images of relevant products and configurations for the BLWD.

