

# The Jarvis Series

BLHJ - High Efficiency High Bay

Project

Date

Part

Type

## About The Jarvis Series

The BLHJ series is a group of superior-grade, suspended mount LED high bay fixtures. It is ideal for indoor use, where energy-efficiency, performance and ease of maintenance is essential. Its rugged design makes it an ideal fixture for high bay applications.

## Specifications

Supported Voltage	120-277V, 347V, 120-347V, 277-480V, 480V
Available Sizes	2', 4'
Lifetime	L70 of 170,000+ hours, L90 of 50,000+ hours
Operating Temperature	-40°C/+40°C standard (-40°C/+55°C upgrade)
Lumens	10L (10000lm) to 96L (96000lm)
CCT	2700K, 3000K, 3500K, 4000K, 5000K, 6500K
CRI	80+ standard, 90+ and 95+ available
Dimming	1-10V Standard
Mounting	Holes provided for V-hangers, S-hook chain-mounting, or aircraft cables, with optional pendant and surface mount brackets
Surge Protection	6kV on lumen packages 18L and above; 20kV surge protection available on all models

## Approvals

- DLC Listed
- DLC Premium\* (select models only)
- ETL Listed
- Dry and Damp Environment Rated
- -40°C Cold Temperature Ready
- Designed and Manufactured in Canada

## Warranty

- | 5 Year Comprehensive, 10 Year LED

# The Jarvis Series

BLHJ - High Efficiency High Bay

Please use the diagram to the right as an example of a completed order code. If you need any assistance contact your local sales representative.

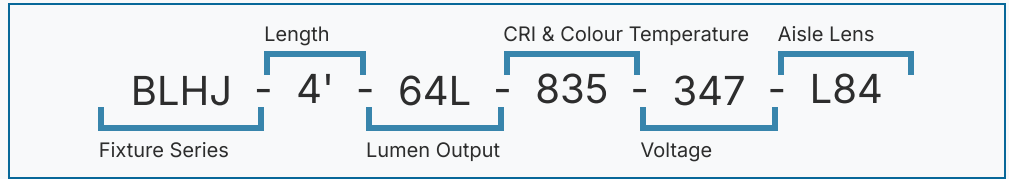

Series	Length & Lumen Output				CRI		CCT		Voltage	
BLHJ	2'-10L	10,000lm	4'-20L	20,000lm	8	80	27	2700K	UNV	120-277V
	2'-12L	12,000lm	4'-24L	24,000lm	9	90+	30	3000K	347	347V
	2'-14L	14,000lm	4'-28L	28,000lm	1	95+	35	3500K	UN3	120-347V
	2'-16L	16,000lm	4'-32L	32,000lm			40	4000K	277-480	277-480V
	2'-18L	18,000lm	4'-36L	36,000lm			50	5000K	480	480V
	2'-20L	20,000lm	4'-40L	40,000lm			65	6500K		
	2'-22L	22,000lm	4'-44L	44,000lm						
	2'-24L	24,000lm	4'-48L	48,000lm						
	2'-28L	28,000lm	4'-56L	56,000lm						
	2'-30L	30,000lm	4'-60L	60,000lm						
	2'-32L	32,000lm	4'-64L	64,000lm						
	2'-36L	34,000lm	4'-72L	72,000lm						
	2'-40L	40,000lm	4'-80L	80,000lm						
	2'-44L	44,000lm	4'-88L	88,000lm						
	2'-48L	48,000lm	4'-96L	96,000lm						

## Options

- Lenses**
- L0 No Lens
  - L69 Glare Control Lens
  - L84 High Performance Aisle Optic Lens
- \* See page 10 for photometrics

- Cords**
- W3xx White 16/3 (Specify Length)
  - W4xx Black 16/3 (Specify Length)
  - W59xx White 18/5 (Specify Length)
  - W\*\*\* Other Options Available\*

Key	Cord Length	Key	Cord Length
6	6FT	15	15FT
10	10FT	20	20FT

Ex. W406 would be 16/3 Black, 6FT

- Dimming**
- B11 0-10V Dimming Leads
  - B12 Line Voltage Dimming
  - B27 Dim-to-off Driver

- Wire Guard**
- G1 Heavy Duty White
  - G5 Heavy Duty Black

- Controls**
- WC10\* Encelium Wireless Controls
  - WC18\* NX Wireless Controls
  - WC19\* Avi-on Wireless Controls
  - WC22\* JDRF Wireless Controls

- Motion Sensors**
- W26 Photocell Motion Sensor
  - W57 Dimming Motion Sensor (dims to 50% when unoccupied)
  - W53\* On/Off
  - W8\* High/Low
  - WX16 Microwave Dimmable Sensor
  - WC31D Keilton/Autani EFS106-AUX Sensor w/ Highbay Lens
  - W\*\* Other Options Available\*

- Temperature Rating**
- BLANK Standard
  - T0 -40C Cold Rated Components

- Electrical**
- B24 UL924 20W Battery Back-up
  - F7 20kV Surge Suppressor
  - F8 UL924 Emergency Relay

- Packaging**
- BLANK Individually Boxed on Pallets
  - P0 Bulk Packaging

- Mounting**
- M1 V-Hangers
  - M2xx V-Hanger with Aircraft Loop Cables
  - M3xx Y-Toggle Aircraft Cables
  - M24 Single Pendant Mount(3/4 Hub)
  - M25 Surface Mount
  - M\*\* Other Options Available\*

Key	Aircraft Length	Key	Aircraft Length
5	5FT	15	15FT
10	10FT	20	20FT

Ex. M305 would be Y-Toggle, 5FT

- Warranty**
- CL7 10-Year Comprehensive Warranty Upgrade

# The Jarvis Series

BLHJ - High Efficiency High Bay

High Bay Lighting by 

## Documentation and Resources







All files and resources are available on our website for download. Files and resources are also embedded as links in this document, listed below. Additional files may be available upon request.

Please contact your local sales agent [here](#) or contact [sales@bjtake.com](mailto:sales@bjtake.com) for more information.

 [BLHJ Installation Instructions - 2024](#)

## Certifications and Listings

Certifications that apply to this fixture and its possible configurations are listed here. More information available upon request.

Icon	Description
	DLC Listed
	DLC Premium* (select models only)
	ETL Listed
	Wireless Controls Available
	90 and 95+ CRI Options Available
	120-347V(UN3) Available

## Usage Applications

This fixture can be used in a variety of applications, and is ideal for the following:

Usage Application
Hospitals
Offices
Schools
Logistics And Warehousing
Manufacturing Plants
Retail Stores
Cold Storage And Freezers
Gymnasiums And Arenas
Professional Sports Facilities

## Warranty Statement

BJ Take products are tested and/or inspected prior to being packaged for shipment and are guaranteed from the day the product is shipped for a period of ten-year LED chip warranty and a five-year comprehensive component warranty. This can be upgraded to a ten-year comprehensive warranty on request.

# The Jarvis Series

BLHJ - High Efficiency High Bay

High Bay Lighting by 

## Wattage Information

Below are the wattage and lumen output tables for all size formats of the BLHJ with the standard L69 glare control lens as well as the L0 'no lens' option.

### BLHJ 2' Wattage

Size	Lumen Package	Lumen Output (L69 Lens)	Lumen Output (No Lens)	Lm/W (L69 Lens)	Lm/W (No Lens)	Wattage
2'	10L	10427	11496	162.67	179.34	64.10
2'	12L	12540	13825	160.66	177.13	78.05
2'	14L	14597	16093	158.66	174.93	92.00
2'	16L	16597	18298	156.65	172.71	105.95
2'	18L	18543	20444	154.65	170.51	119.90
2'	20L	20451	22525	152.64	168.29	133.85
2'	22L	22263	24545	150.63	166.07	147.80
2'	24L	24038	26502	148.61	163.84	161.75
2'	28L	28890	31851	159.88	176.27	180.70
2'	30L	30750	33902	157.97	174.16	194.66
2'	32L	32557	35894	156.06	172.05	208.62
2'	36L	36463	40200	154.15	169.95	236.54
2'	40L	40261	44388	152.24	167.84	264.46
2'	44L	43953	48458	150.33	165.74	292.38
2'	48L	47552	52426	148.40	163.63	320.40

### BLHJ 4' Wattage

Size	Lumen Package	Lumen Output (L69 Lens)	Lumen Output (No Lens)	Lm/W (L69 Lens)	Lm/W (No Lens)	Wattage
4'	20L	20415	22508	159.24	175.57	128.20
4'	24L	24539	27054	157.40	173.54	155.90
4'	28L	28563	31491	155.57	171.52	183.60
4'	32L	32483	35813	153.73	169.49	211.30
4'	36L	36304	40025	151.90	167.47	239.00
4'	40L	40021	44123	150.06	165.44	266.70
4'	44L	43639	48112	148.23	163.42	294.40
4'	48L	47143	51975	146.36	161.36	322.10
4'	56L	57149	63007	157.09	173.19	363.80
4'	60L	60866	67105	155.29	171.21	391.95
4'	64L	64481	71090	153.49	169.22	420.10
4'	72L	72260	79667	151.68	167.23	476.40
4'	80L	79841	88025	149.88	165.24	532.70
4'	88L	87219	96159	148.08	163.26	589.00
4'	96L	94375	104048	146.25	161.24	645.30

### BLHJ Light Loss Factor (LLF)

CCT	Scaling Factor
3500	97.19
4000	100.00
5000	100.00
90CRI	85.90

### BLHJ Lens Scaling

Order Code	Lens	Scaling Factor
L69	Glare Control Lens	100.00
L81	30x60 Aisle Optic	100.43
L82	10x60 Aisle Optic	101.74
L0	No Lens	110.25

\* Actual lumen output may vary

# The Jarvis Series

BLHJ - High Efficiency High Bay

High Bay Lighting by **BJTAKE**  
LIGHTING

## BLHJ 2' 10L-24L Dimensions

Below are the dimensions for the 2' 10L-24L BLHJ configurations.

### 2' 10L-24L Standard

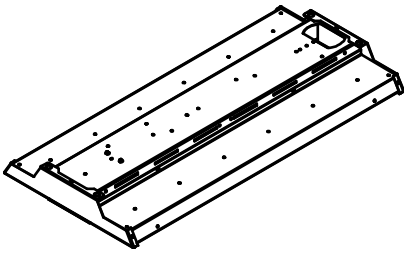

### 2' 10L-24L Standard End

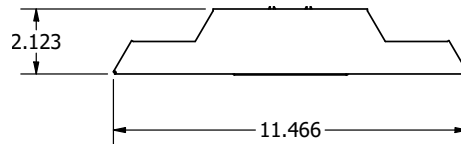

### 2' 10L-24L Standard Side

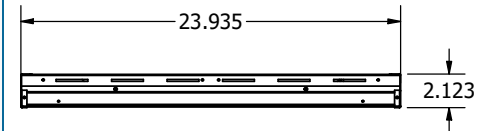

### 2' 10L-24L Pendant

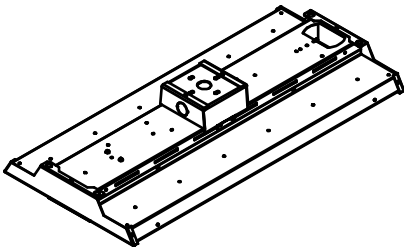

### 2' 10L-24L Pendant End

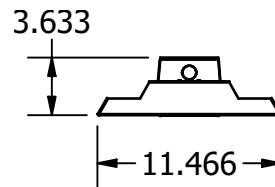

### 2' 10L-24L Pendant Side

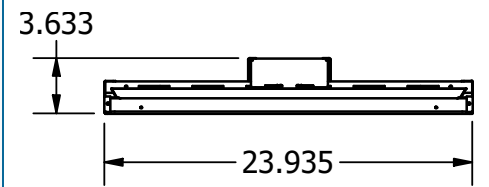

### 2' 10L-24L Battery

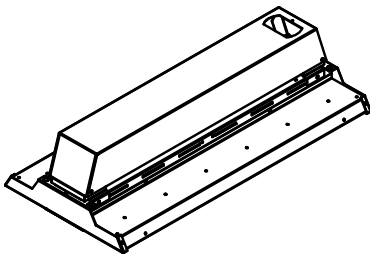

### 2' 10L-24L Battery End

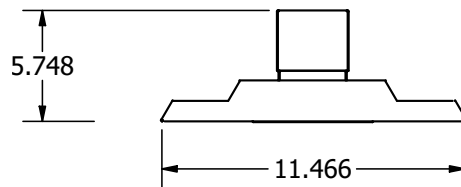

### 2' 10L-24L Battery Side

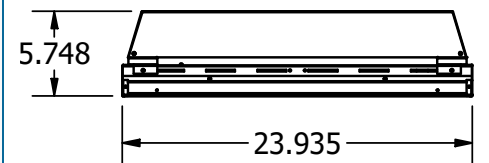

### Pendant View

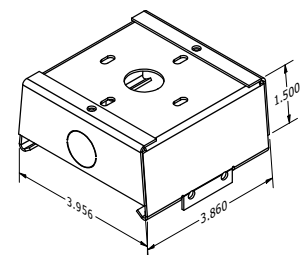

## BLHJ 2' 28L-48L Dimensions

Below are the dimensions for the 2' 28L-48L BLHJ configurations.

### 2' 28L-48L Standard

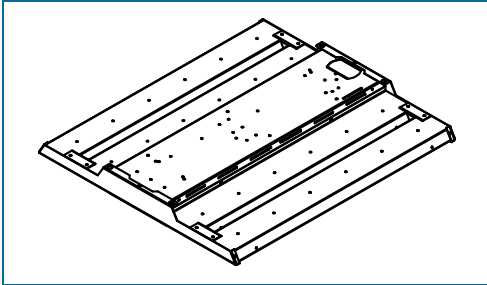

### 2' 28L-48L Standard End

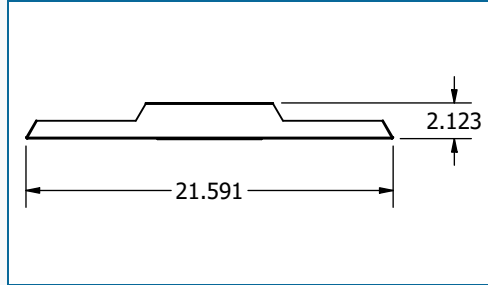

### 2' 28L-48L Standard Side

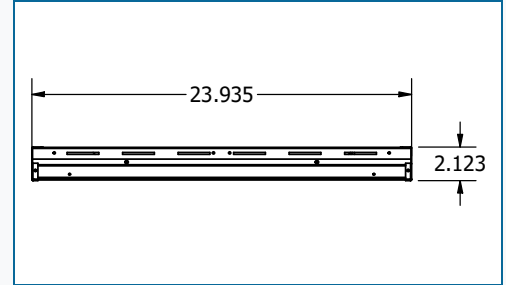

### 2' 28L-48L Pendant

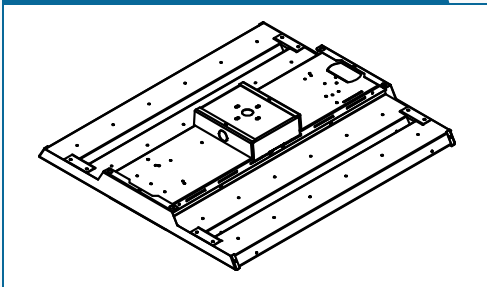

### 2' 28L-48L Pendant End

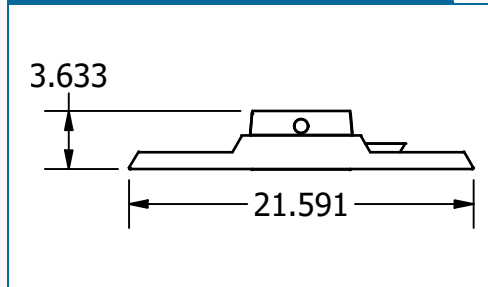

### 2' 28L-48L Pendant Side

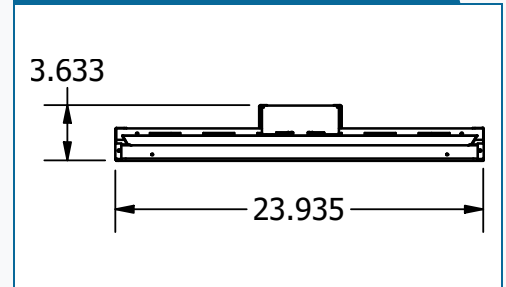

### 2' 28L-48L Battery

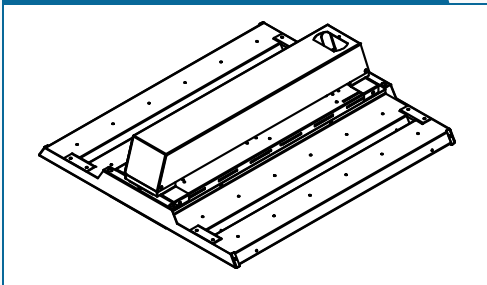

### 2' 28L-48L Battery End

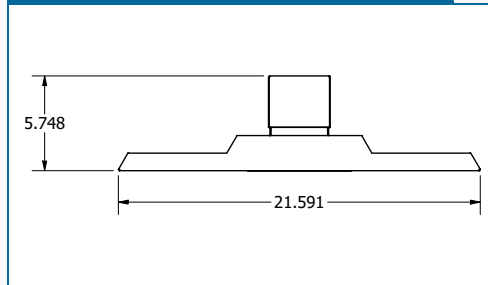

### 2' 28L-48L Battery Side

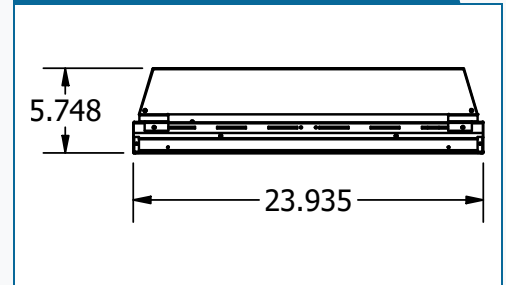

### Pendant View

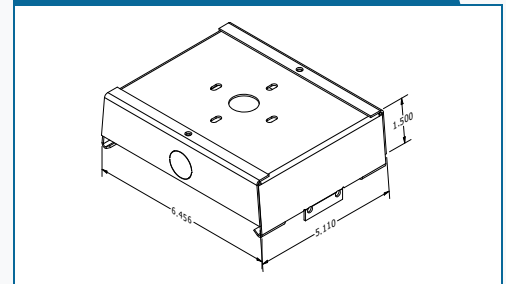

## BLHJ 4' 20L-48L Dimensions

Below are the dimensions for the **4' 20L-48L** BLHJ configurations.

### 4' 20L-48L Standard

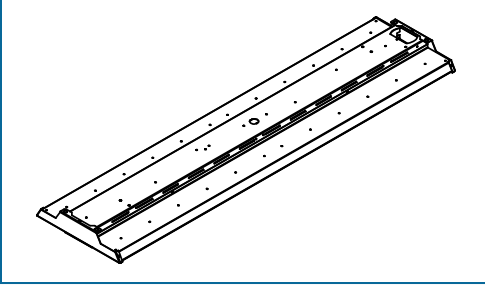

### 4' 20L-48L Standard End

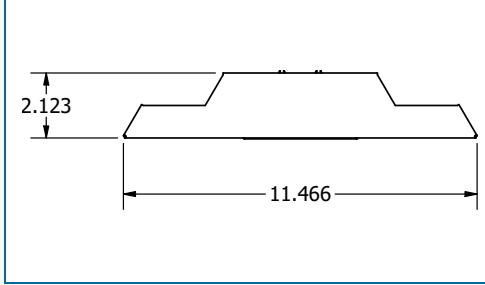

### 4' 20L-48L Standard Side

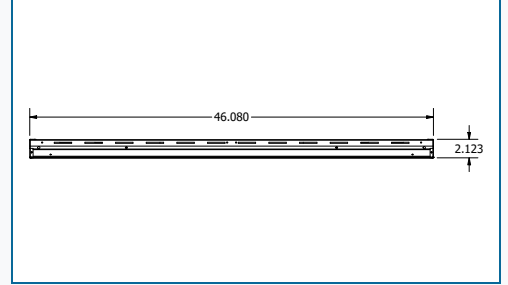

### 4' 20L-48L Pendant

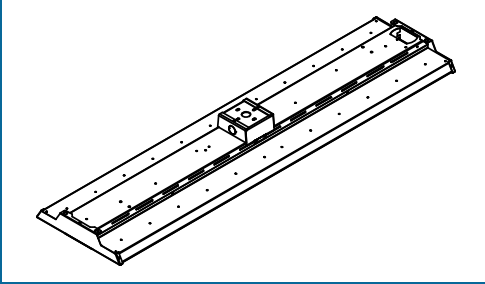

### 4' 20L-48L Pendant End

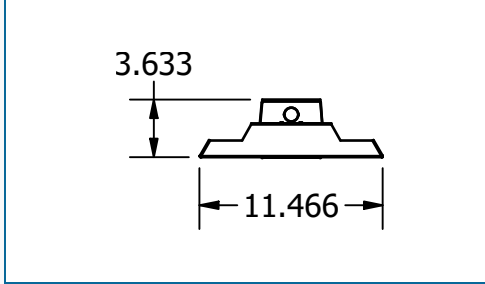

### 4' 20L-48L Pendant Side

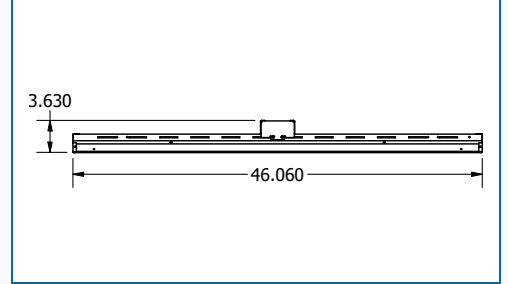

### 4' 20L-48L Battery

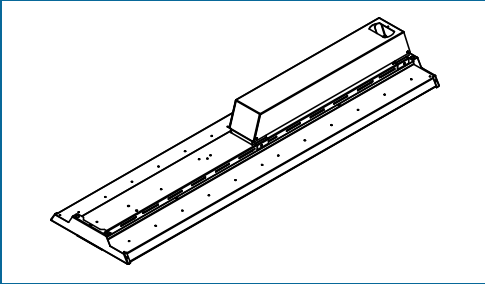

### 4' 20L-48L Battery End

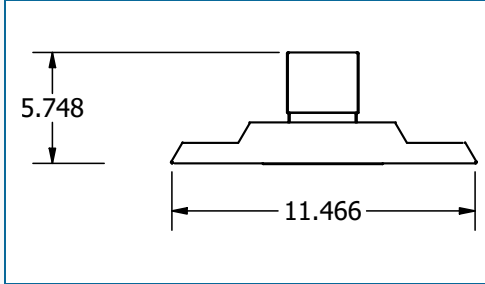

### 4' 20L-48L Battery Side

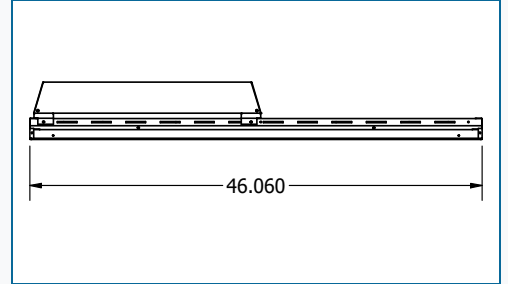

### Pendant View

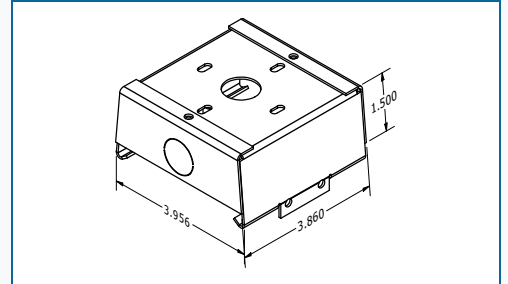

## BLHJ 4' 56L-96L Dimensions

Below are the dimensions for the **4' 56L-96L** BLHJ configurations.

### 4' 56L-96L Standard

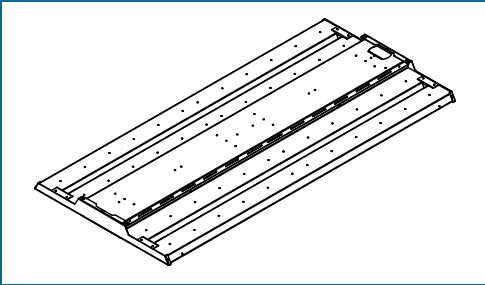

### 4' 56L-96L Standard End

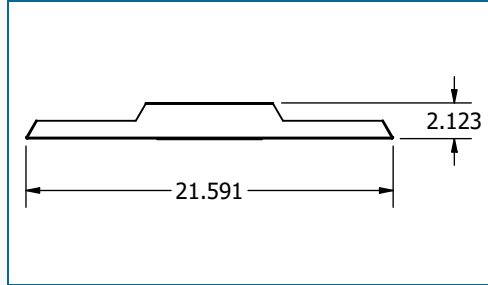

### 4' 56L-96L Standard Side

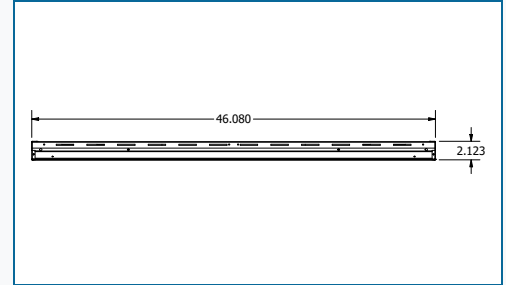

### 4' 56L-96L Pendant

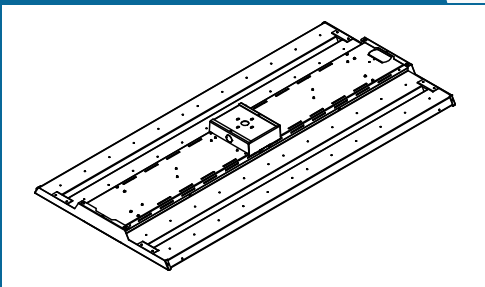

### 4' 56L-96L Pendant End

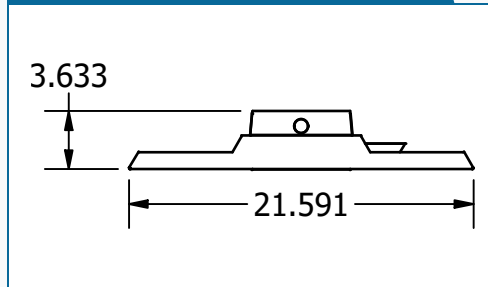

### 4' 56L-96L Pendant Side

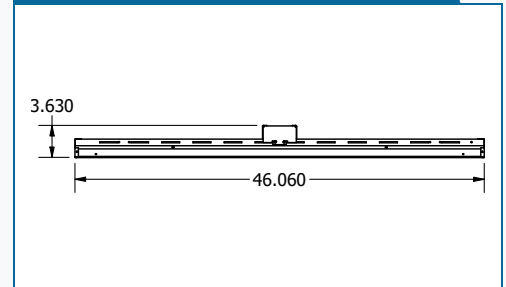

### 4' 56L-96L Battery

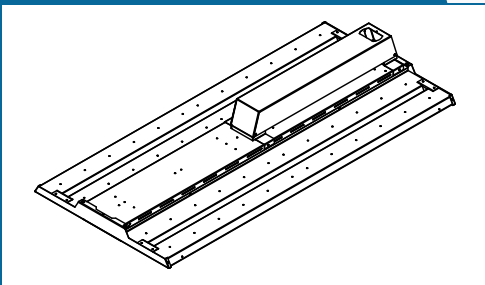

### 4' 56L-96L Battery End

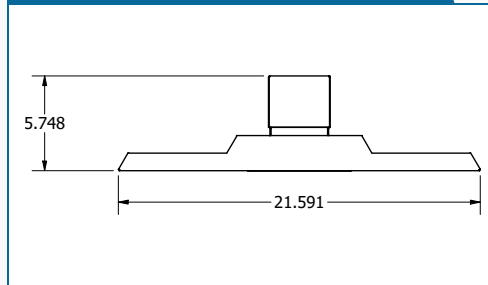

### 4' 56L-96L Battery Side

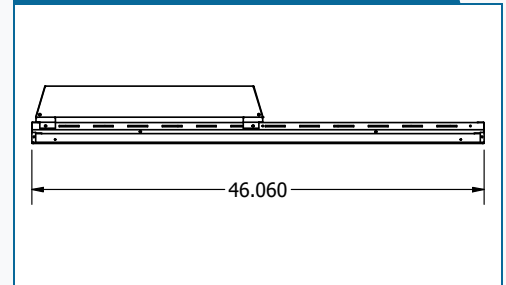

### Pendant View

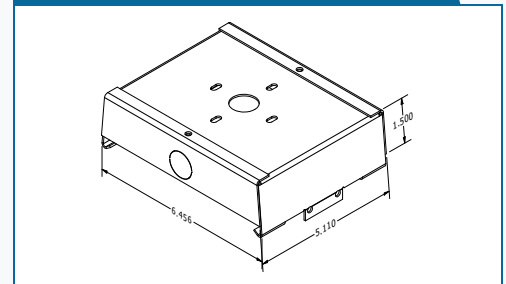

# The Jarvis Series

BLHJ - High Efficiency High Bay

## 1 - BLHJ-2'-48L-850-L69

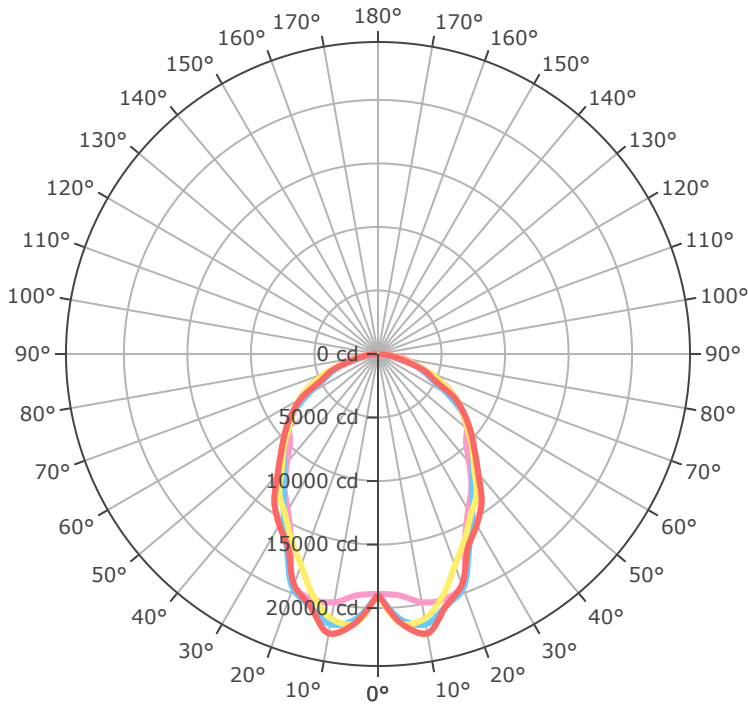

- 0.0°
- 45.0°
- 90.0°
- 135.0°
- 180.0°

Mtg Height	Light Level	Beam Diameter
6.0 ft	524.5 fc	14.5 ft
8.0 ft	295.0 fc	19.3 ft
10.0 ft	188.8 fc	24.2 ft
12.0 ft	131.1 fc	29.0 ft
14.0 ft	96.3 fc	33.8 ft
16.0 ft	73.8 fc	38.7 ft
24.0 ft	32.8 fc	58.0 ft
32.0 ft	18.4 fc	77.3 ft
40.0 ft	11.8 fc	96.6 ft
48.0 ft	8.2 fc	116.0 ft
56.0 ft	6.0 fc	135.3 ft
64.0 ft	4.6 fc	154.6 ft

## 2 - BLHJ-4'-96L-850-L69

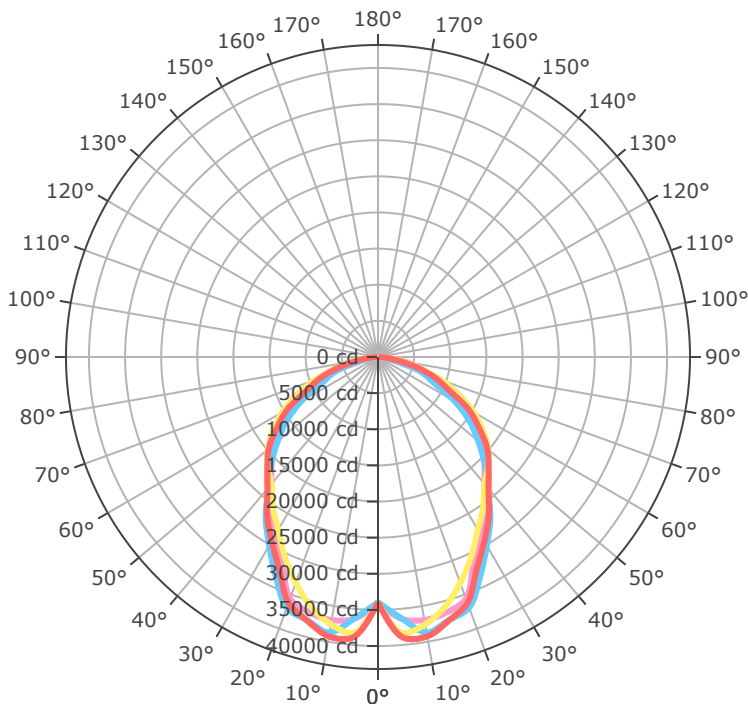

- 0.0°
- 45.0°
- 90.0°
- 135.0°
- 180.0°

Mtg Height	Light Level	Beam Diameter
6.0 ft	942.9 fc	17.2 ft
8.0 ft	530.4 fc	23.0 ft
10.0 ft	339.4 fc	28.7 ft
12.0 ft	235.7 fc	34.5 ft
14.0 ft	173.2 fc	40.2 ft
16.0 ft	132.6 fc	46.0 ft
24.0 ft	58.9 fc	69.0 ft
32.0 ft	33.1 fc	91.9 ft
40.0 ft	21.2 fc	114.9 ft
48.0 ft	14.7 fc	137.9 ft
56.0 ft	10.8 fc	160.9 ft
64.0 ft	8.3 fc	183.9 ft

# The Jarvis Series

BLHJ - High Efficiency High Bay

3 - BLHJ-4'-60L-840-L84

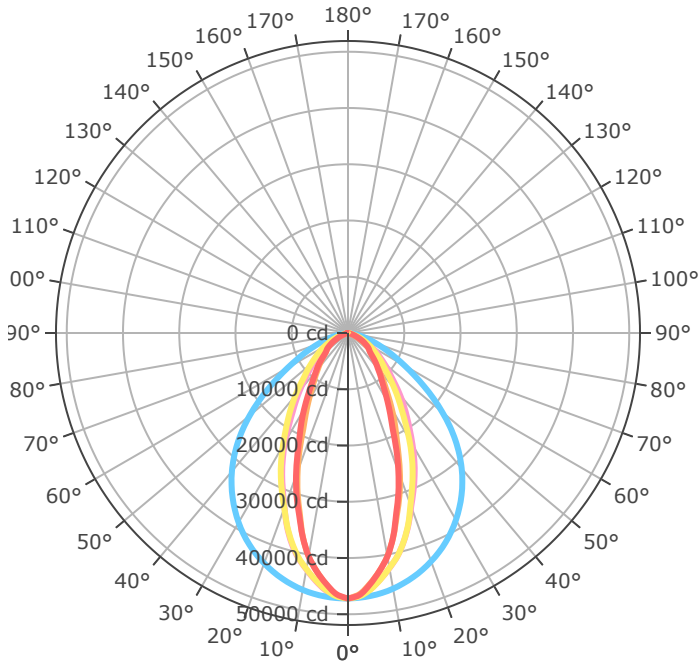

- 0.0° - 180.0°
- 45.0° - 225.0°
- 90.0° - 270.0°
- 135.0° - 315.0°
- 180.0° - 360.0°

Mtg Height	Light Level	Beam Diameter
6.0 ft	1310.9 fc	5.0 ft
8.0 ft	737.4 fc	6.6 ft
10.0 ft	471.9 fc	8.3 ft
12.0 ft	327.7 fc	9.9 ft
14.0 ft	240.8 fc	11.6 ft
16.0 ft	184.4 fc	13.2 ft
24.0 ft	81.9 fc	19.8 ft
32.0 ft	46.1 fc	26.4 ft
40.0 ft	29.5 fc	33.0 ft
48.0 ft	20.5 fc	39.6 ft
56.0 ft	15.0 fc	46.2 ft
64.0 ft	11.5 fc	52.8 ft

# The Jarvis Series

BLHJ - High Efficiency High Bay

## Emergency Driver, Activated Output

Lumen Package(2FT)	Lumen Output(lm)	Lumen Package(4FT)	Lumen Output(lm).1
10L	3700lm	20L	3700lm
12L	3700lm	24L	3700lm
14L	3700lm	28L	3700lm
16L	3700lm	32L	3700lm
18L	3700lm	36L	3700lm
20L	3700lm	40L	3700lm
22L	3700lm	44L	3700lm
24L	3700lm	48L	3700lm
26L	3700lm	56L	3700lm
28L	3700lm	60L	3700lm
30L	3700lm	64L	3700lm
32L	3700lm	72L	3700lm
36L	3700lm	80L	3700lm
40L	3700lm	88L	3700lm
44L	3700lm	96L	3700lm
48L	3700lm	NaN	NaN

\*activated output cannot exceed selected lumen package output

## Emergency Battery Plan - 20W

Emergency Lighting	Solution System Components	System Operation
Option Code 'B17' - UL 924 listed components that are factory installed in the luminaire	UL 924 listed 20-watt battery integral to the luminaire	Loss of normal power is detected by the B17 emergency light solution and the power supply is switched automatically to the 20-watt integral battery pack which powers the emergency LED lighting driver.
	UL 924 listed LED emergency lighting driver integral to the luminaire	The battery pack and emergency LED driver are UL 924 certified to provide a minimum of 90-minutes of emergency lighting.
	Wiring options for both switched and unswitched emergency lighting	

## Emergency Lighting Wiring

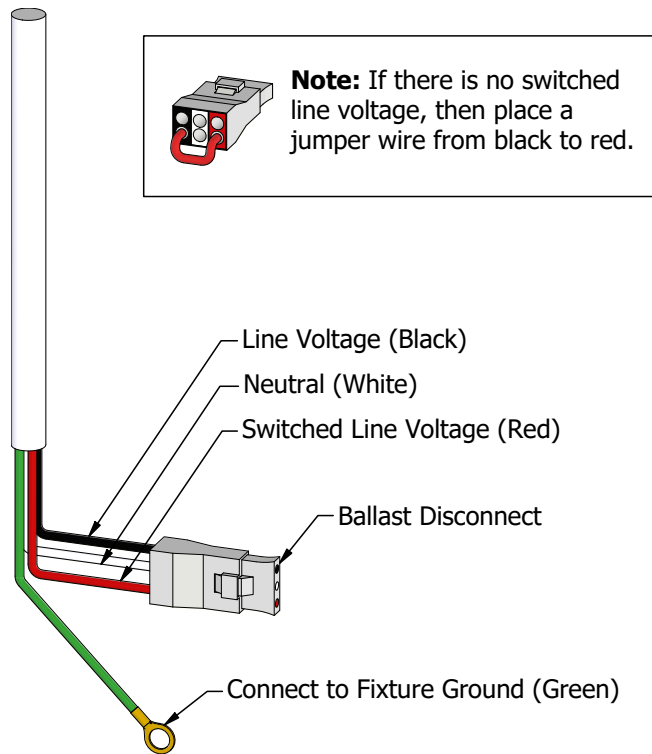

## Important Information

More information on emergency lighting options and configurations available on request.

# The Jarvis Series

BLHJ - High Efficiency High Bay

## Gallery Information

Below you will find images of relevant products and configurations for the BLHJ.

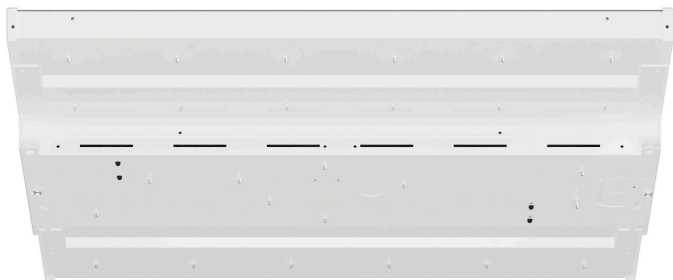

# The Jarvis Series

BLHJ - High Efficiency High Bay

## Gallery Information

Below you will find images of relevant products and configurations for the BLHJ.

