

The Quinn Series

BLMQ - Wall Mount Linear

Project

Date

Part

Type



About The Quinn Series

The BLMQ is an LED linear fixture designed for wall mounting. It is well suited for indoor use where high efficiency, task lighting is required. Its narrow design and modern profile make it an ideal fixture for task lighting applications. This versatile solution can also be ceiling or suspended mounted, and the optional divider and up-light can be removed for the lens to be fully illuminated from one light source.

Specifications

Supported Voltage	120-277V, 120-347V, 277V, 347V, 480V
Available Sizes	2', 3', 4'
Lifetime	L70 of 90,000+ hours
Operating Temperature	-20°C/+25°C
Lumens	Lumen output ranging from 0.25L/ft to 1.0L/ft
CCT	2700K, 3000K, 3500K, 4000K, 5000K, 6500K
CRI	80+ standard, 90+ and 95+ available
Dimming	0-10V Standard

Approvals

- ETL Listed
- Dry and Damp Environment Rated
- Designed and Manufactured in Canada

Warranty

- | 5 Year Comprehensive, 10 Year LED

The Quinn Series

BLMQ - Wall Mount Linear

Linear Lighting by **BJTAKE** LIGHTING

Please use the diagram to the right as an example of a completed order code. If you need any assistance contact your local sales representative.

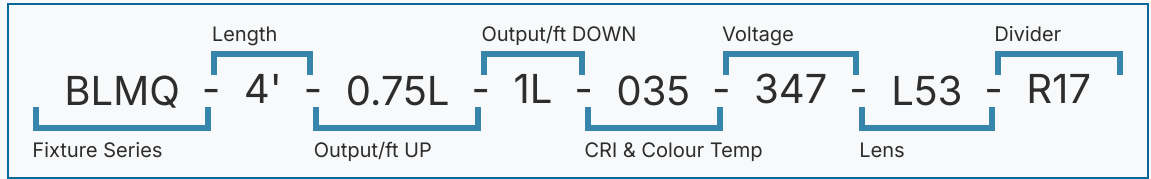

1	2	3	4	5	6	7
BLMQ						

Series	Size	Output/ft UP		Output/ft DOWN		CRI		CCT		Voltage	
BLMQ	2'	BLANK	None	BLANK	None	8	80	27	2700K	UNV	120-277V
	3'	0.25L	250 lm/ft	0.25L	250 lm/ft	9	90+	30	3000K	277	277V
	4'	0.50L	500 lm/ft	0.50L	500 lm/ft	1	95+	35	3500K	347	347V
		0.75L	750 lm/ft	0.75L	750 lm/ft	0	THRIVE	40	4000K	UN3	120-347V
		1L	1000 lm/ft	1L	1000 lm/ft	50		65	5000K	480	480V
									6500K		

Note: If no up light is selected and the R17 light divider is not included as an option, the BLMQ will be assembled as a general lighting fixture intended to face downwards rather than the horizontal wall mount configuration.

8

Options

Lenses

L53	Opal Lens
-----	-----------

Divider

BLANK	Not required
R17	Up/Down Light Divider

Dimming

B11	0-10V Dimming Leads
B12	Line Voltage Dimming
B27	Dim-to-off Driver
B**	Other Options Available*

Wireless Controls

WCAWN	Lutron Athena (Node)
WCAWNS	Lutron Athena (Sensor)
WC10	Encelium
WC18	NX Wireless
WC19	Avi-on
WC22	JDRF Autonomy
WC31	Keilton
WCxx	Other Options Available*

Motion Sensors

W26	Photocell Motion Sensor
W57	Dimming Motion Sensor (dims to 50% when unoccupied)
W53*	On/Off
W8*	High/Low
WX16	Microwave Dimmable Sensor
W**	Other Options Available*

Mounting

BLANK	Surface Wall Mount
M1	V-Hangers
M2xx	V-Hanger with Aircraft Loop Cables
M3xx	Y-Toggle Aircraft Cables
M24	Single Pendant Mount(3/4 Hub)
M36	Knock-outs on both ends
M62xx	Aircraft Loop Kits w/ Side Exit Cable Grippers
M**	Other Options Available*

Canopy

M35xx	White canopy kits for T-bar or j-box mounting
M61xx	Black canopy kits for j-box mounting

Emergency Driver

B17	UL924 10W Battery Back-up
F8	UL924 Emergency Relay

Switches

S1	On/Off Pull Chain
S2	3-Way Pull Chain

Finish

BLANK	Standard Matte White
C5	Matte Black
CUSTOM*	Custom Colour Choice

Packaging

BLANK	Individually Boxed on Pallets
P0	Bulk Packaging
P**	Other Options Available*

Warranty

CL7	10-Year Comprehensive Warranty Upgrade
-----	--

Documentation and Resources

All files and resources are available on our website for download. Files and resources are also embedded as links in this document, listed below. Additional files may be available upon request.





Please contact your local sales agent [here](#) or contact sales@bjtake.com for more information.

 [BLMQ - Installation Instructions](#)

 [BLMQ - Photometry](#)

Certifications and Listings

Certifications that apply to this fixture and its possible configurations are listed here. More information available upon request.

Icon	Description
	Wireless Controls Available
	90 and 95+ CRI Options Available
	120-347V(UN3) Available
	ETL Listed

Usage Applications

This fixture can be used in a variety of applications, and is ideal for the following:

Usage Application
Grocery Stores
Hospitals
Manufacturing Facilities
Offices
Retail Stores
Schools
Storage Facilities
Surface Mount
Suspended

Warranty Statement

BJ Take products are tested and/or inspected prior to being packaged for shipment and are guaranteed from the day the product is shipped for a period of ten-year LED chip warranty and a five-year comprehensive component warranty. This can be upgraded to a ten-year comprehensive warranty on request.

The Quinn Series

BLMQ - Wall Mount Linear

BLMQ Dimensions

2' (ft) model

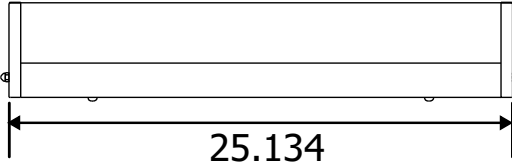

3' (ft) model

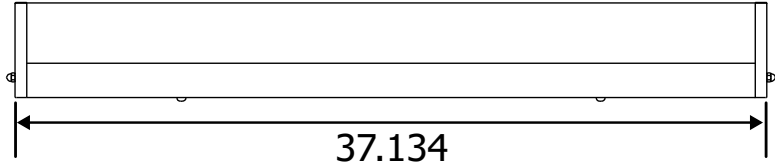

4' (ft) model

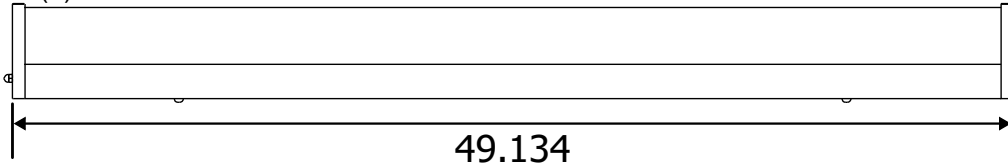

View **no** divider and **no** up-light

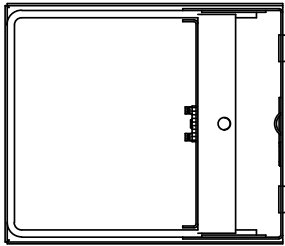

View **with** R17 divider, up and down light

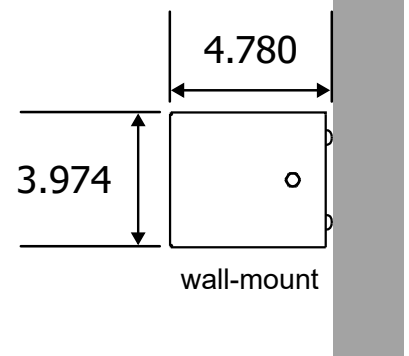
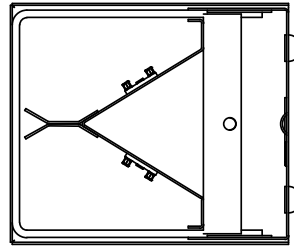

BLMQ Wattage

Fixture Size	Lumen Output per Ft.	Wattage	Lm/W
2'	0.25	3.95	133
2'	0.50	7.75	130
2'	0.75	12.15	126
2'	1.00	16.65	122
3'	0.25	5.92	133
3'	0.50	11.63	130
3'	0.75	18.23	126
3'	1.00	24.97	122
4'	0.25	7.90	133
4'	0.50	15.50	130
4'	0.75	24.30	126
4'	1.00	33.30	122

* Drawings not to scale

* Standard tolerances apply

* Specifications may change without notice

The Quinn Series

BLMQ - Wall Mount Linear

BLMQ-4'-4L-4L-840-UNV-L53

This photometry data is produced from a model containing both an up and down light, as well as a divider.

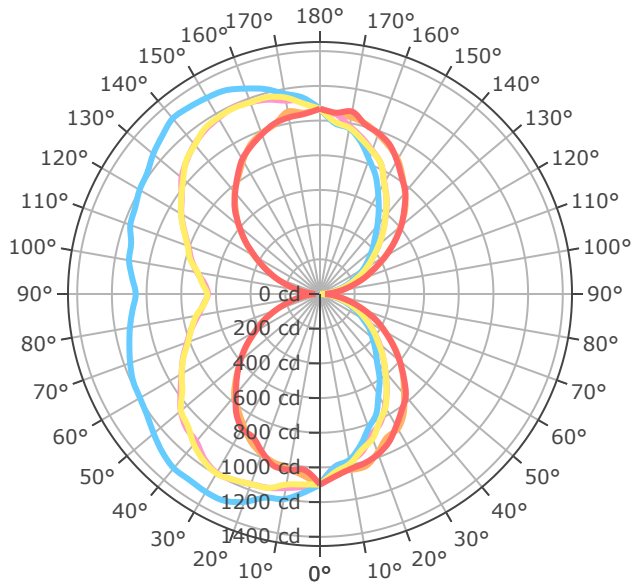

- 0.0° - 180.0°
- 45.0° - 225.0°
- 90.0° - 270.0°
- 135.0° - 315.0°
- 180.0° - 360.0°

Mtg Height	Light Level	Beam Diameter
6.0 ft	30.5 fc	16.0 ft
8.0 ft	17.2 fc	21.3 ft
10.0 ft	11.0 fc	26.7 ft
12.0 ft	7.6 fc	32.0 ft
14.0 ft	5.6 fc	37.3 ft
16.0 ft	4.3 fc	42.7 ft
24.0 ft	1.9 fc	64.0 ft
32.0 ft	1.1 fc	85.3 ft
40.0 ft	0.7 fc	106.7 ft
48.0 ft	0.5 fc	128.0 ft
56.0 ft	0.4 fc	149.3 ft
64.0 ft	0.3 fc	170.7 ft

BLMQ-4'-4L-4L-840-UNV-L53

This photometry data is for models without a divider and only containing one light source.

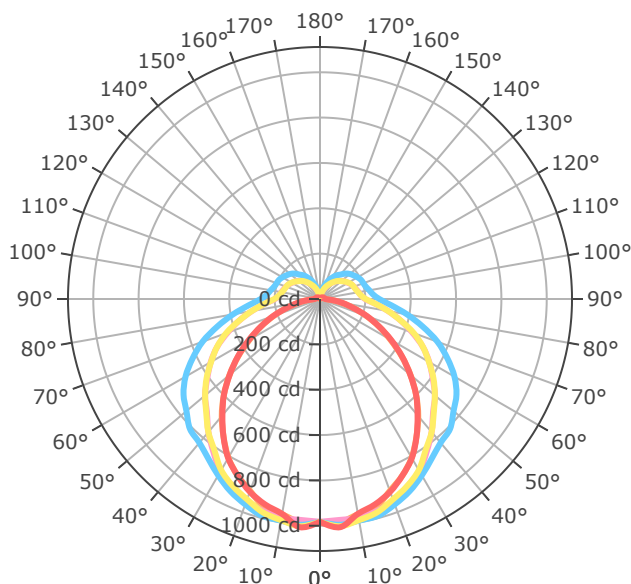

- 0.0°
- 45.0°
- 90.0°
- 135.0°
- 180.0°

Mtg Height	Light Level	Beam Diameter
6.0 ft	27.3 fc	15.3 ft
8.0 ft	15.4 fc	20.3 ft
10.0 ft	9.8 fc	25.4 ft
12.0 ft	6.8 fc	30.5 ft
14.0 ft	5.0 fc	35.6 ft
16.0 ft	3.8 fc	40.7 ft
24.0 ft	1.7 fc	61.0 ft
32.0 ft	1.0 fc	81.4 ft
40.0 ft	0.6 fc	101.7 ft
48.0 ft	0.4 fc	122.1 ft
56.0 ft	0.3 fc	142.4 ft
64.0 ft	0.2 fc	162.7 ft

Emergency Battery Plan - 10W

Emergency Lighting	Solution System Components	System Operation
Option Code 'B17' - UL 924 listed components that are factory installed in the luminaire	UL 924 listed 10-watt battery integral to the luminaire	Loss of normal power is detected by the B17 emergency light solution and the power supply is switched automatically to the 10-watt integral battery pack which powers the emergency LED lighting driver.
	UL 924 listed LED emergency lighting driver integral to the luminaire	The battery pack and emergency LED driver are UL 924 certified to provide a minimum of 90-minutes of emergency lighting.
	Wiring options for both switched and unswitched emergency lighting	

Emergency Lighting Wiring

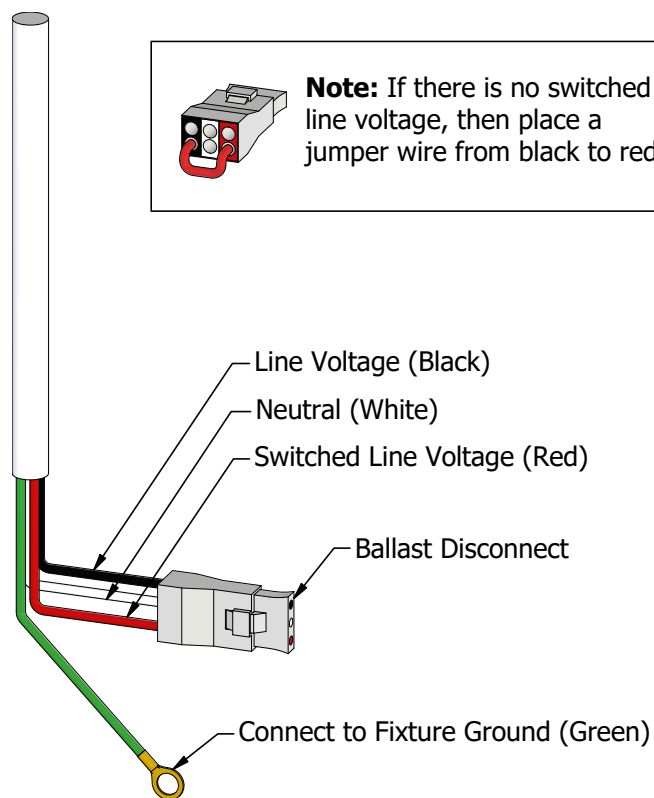

Important Information

More information on emergency lighting options and configurations available on request.

THRIVE™ is an **optional** natural daylight technology replacing typical CRI order codes.



THRIVE™ Human-Centric Lighting

Order Code	Option	Use-case
8	80 CRI	Energy-efficient, lower cost, acceptable colour rendering for general lighting applications.
9	90 CRI	More accurate, natural and vibrant colour appearance. Suitable for retail, offices, and applications where colour accuracy is of higher importance.
1	95+ CRI	Near-perfect colour fidelity, excellent for architectural, medical, retail, and other premium applications.
0	THRIVE	Human-centric lighting engineered to provide the most accurate recreation of natural daylight. Highly beneficial for healthcare, office environments, schools and other applications where all-day comfort and general well-being are top priorities.

Engineered to provide the closest match to natural light available using proprietary chip, phosphor, and packaging technology, Thrive can be used in constant colour point luminaires to bring full spectrum natural light indoors, or in tunable white luminaires to incorporate circadian elements that may impact human well-being.

The high-fidelity spectral output of Thrive creates stunning environments with excellent colour rendering and outstanding TM-30 metrics. Target applications include office, education, healthcare, retail, hospitality, architectural, museums, and residential lighting.

[Bridgelux White Paper - Average Spectral Difference.pdf](#)

The effect of the THRIVE™ spectral power distributions at a CCT of 4000K (typical for interior lighting in commercial, office, and education settings) is shown in the figure below. The reference light source at this colour temperature is firelight, represented diagrammatically as the blackbody curve (BBC) and referenced in the below figure as natural light. LEDs offering a CRI of 90 or 98 have a closer match to the blackbody curve than the 80 CRI light source. Nevertheless, across the entire visual spectrum, both light sources show a substantial deviation from the natural light BBC. This is shown in the spectral spikes (deviations above the blackbody curve) and valleys (deviations below the blackbody curve).

Spectral power distributions of LED light sources at 4000K against the blackbody curve.

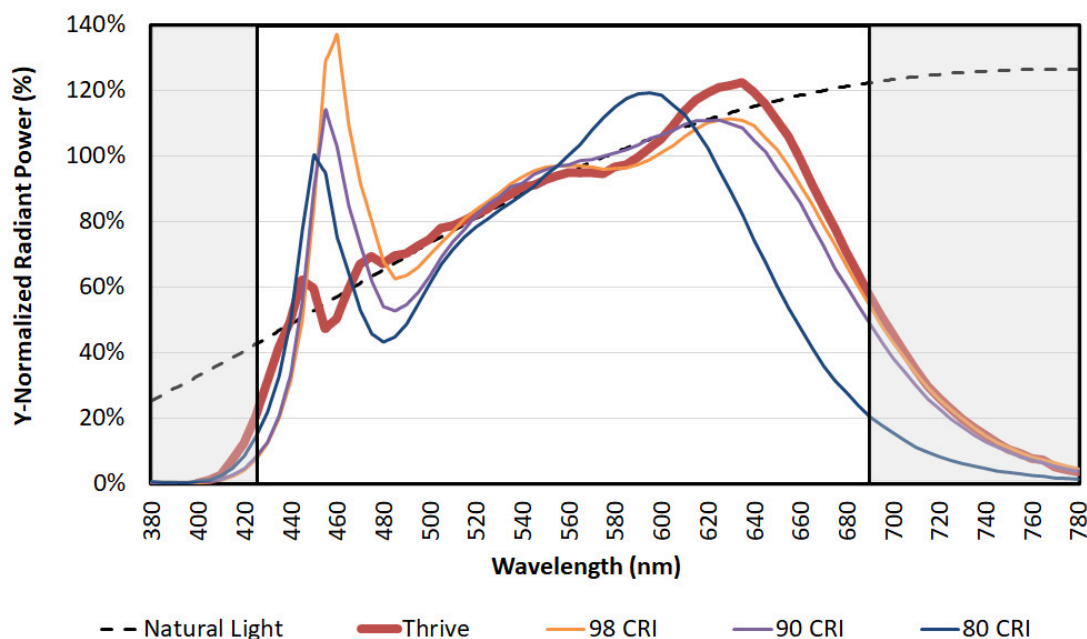

Gallery Information

Below you will find images of relevant products and configurations for the BLMQ.

